

# Installation i4F Drop-Lock Technologies: Herringbone

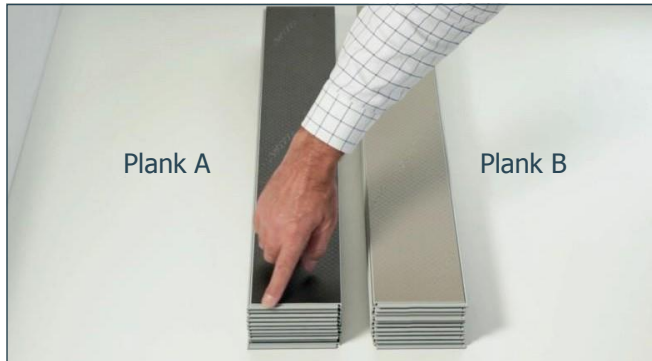

**Com4-sided 3L TripleLock Herringbone**  
One piece drop-lock system.



**Preparation**  
Tools needed: a tape measure, pen, cutter knife, T-square, soft rubber mallet, disassembling wedge.

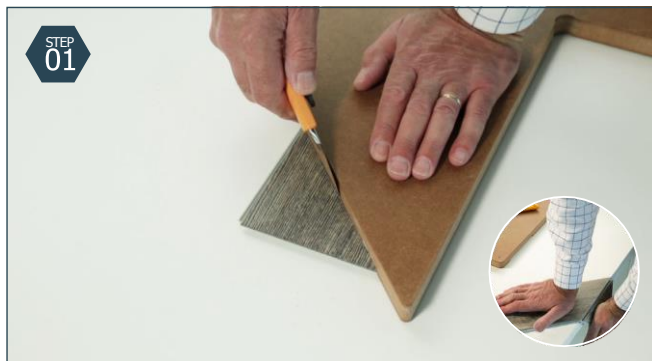

**STEP 01**  
**Cutting planks**  
Lay down the first plank (A) on a leveled surface and place the T-square on top. Make sure the T-square is placed exactly on the corner. While holding down, make an initial cut with the cutter knife. Next, place the plank on a higher surface and push down the pre-cut part of the plank to make it snap. Pull the snapped piece upwards to remove completely.



**STEP 02**  
**Install 1st plank**  
Place the first plank (A) with the cut side against the wall at a 45° angle.



**STEP 03**  
**Install 2nd plank**  
Take a second plank (B) and drop it with the long side engaging against the first plank (A) on the short side.

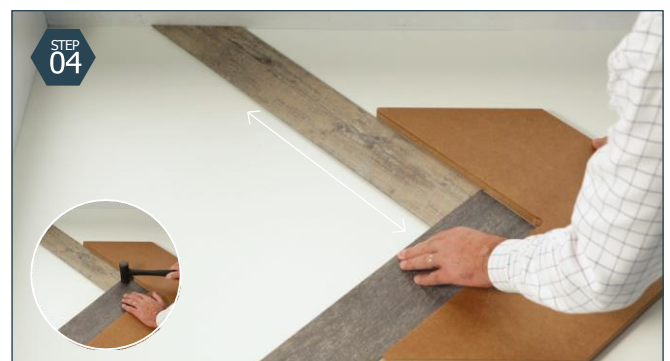

**STEP 04**  
**Align and lock**  
Use the T-square to align the two planks perfectly. Then, tap gently with the soft rubber mallet to lock the planks.



**Install 3rd plank**

Place a third plank (A) with the long side engaging against the second plank (B) on the short side. Again, use the T-square to align the two planks perfectly and tap gently with the soft rubber mallet to lock the planks. Make sure the profile of all planks is facing inwards.

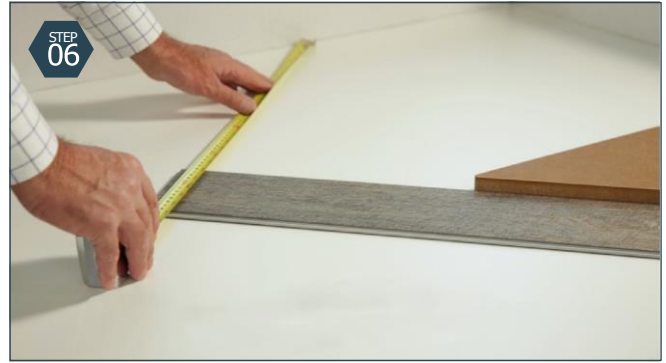

**Last plank in row**

Repeat the process until you reach the other wall. Once there, measure the distance from the plank to the wall (including the width of the plank). Mark the measured length of the final plank and cut the plank at a 45° angle at the measure length. Then place the plank following the previous instructions.

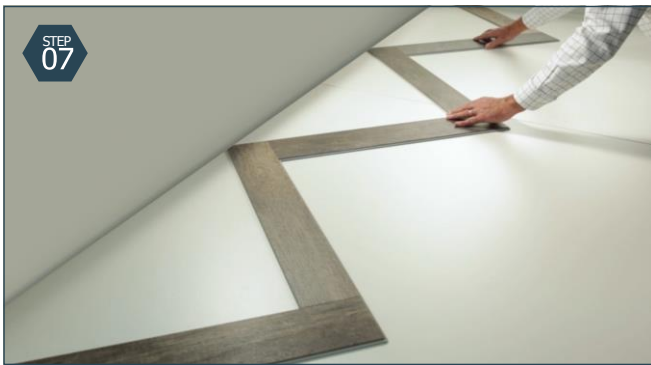

**Align row against wall**

After finishing the first row of assembled planks, push it gently all the way against the wall.



**Fill in the gaps**

Continue by filling in the gaps towards the wall, cutting and measuring the planks as you have previously done. To connect the new plank to the previously assembled row, lift up the assembled planks. Slide the new plank underneath and drop down the assembled planks. Always alternate planks A and B until you have filled all gaps. Don't forget to lock the planks.



**First planks a, then planks b**

Continue each next row by placing all the planks A in a row first, followed by all the planks B. Continue in this way up to the opposite wall is reached. Fill the remaining openings as in figure 7.

## SUBFLOOR PREPARTION

Subfloor surface must be smooth, flat, dry, clean, and solid. Carpet staples or adhesive residue must be removed to insure proper installation. Subfloors should be 100%.

We recommend fitting this product with our specific Underlay Supremo Vinyl 1.5mm (Unless the product has pre-applied underlay already, in this case do not use any type of underlay but the pre-applied underlay).

It needs to be installed on top of a 100% straight, rigid, and even subfloor (We highly recommend using self-leveling compound to reach high enough degree of evenness).

When installing on top of screed the screed moisture must not exceed 2%.

**Installation Highlight** : If the sub floor is made of wood floorboards a minimum 18mm plywood should be applied and secured before fitting the LVT.

We strongly recommend that Vinyl flooring tiles must be installed only on dry screed subfloor and only **by a professional fitter**.

Installing this product on top of an uneven subfloor or unsuitable underlay will cause the click system to fail and the floor to get damaged over time.

You must create an expansion gap or barrier every 30m<sup>2</sup> when fitting LVT. Voids or humps in the subfloor will prevent Strong SPC Structure from locking properly. Subfloors must be carefully checked for moisture problems. Strong SPC Structure is water-resistant. It is NOT a water-proofer.

Any moisture problems need to be addressed prior to installation. New concrete floors need to cure for 2.5% Moisture content.

1. Fitting around irregular objects is no problem. Simply make a pattern out of heavy paper to fit around pipes or irregular objects. Place the pattern upon the plank and trace. Cut along trace lines using a utility knife or heavy-duty scissors, and lay plank. Be sure to leave 8-10 mm expansion space around all fixed objects, floor vents and door frames.

\*\* When the Room width is over 7.5m - you will need to ensure you create expansion Gap to avoid high tension and pressure Between planks.

2. When coming to a doorway, we recommend the use of T-Bar to separate rooms and hallways. Be sure to leave 8-10 mm expansion space under the T-moldings.

3. When installing Supremo Click SPC flooring, you should NOT install under Kitchen cabinets, Islands. Since your floor will be floating on the sub-floor and connected solely by the locking system, it needs space to expand and contract with temperature changes.

4. - Please review our LVT Fitting Guide for all essential fitting requirements.

BS 8203:2017 Installation of resilient floor coverings - code of practice

All fitting instruction are subject to and in line with British Standards: BS 8201

Disclaimer: Installation guidance is advisory and is based on established good practice and the BS-8201-2011 standard. It is the fitter's responsibility to follow these procedures before, during and after installation. We cannot accept responsibility for any issues relating to installation.